

SERVICE PARTS LIST

GROUP:	22
FORM:	8TA
FILE:	Alternator Parts List Section
DATE:	August, 2006

MODEL	VOLTS	AMPS
Various See Chart		

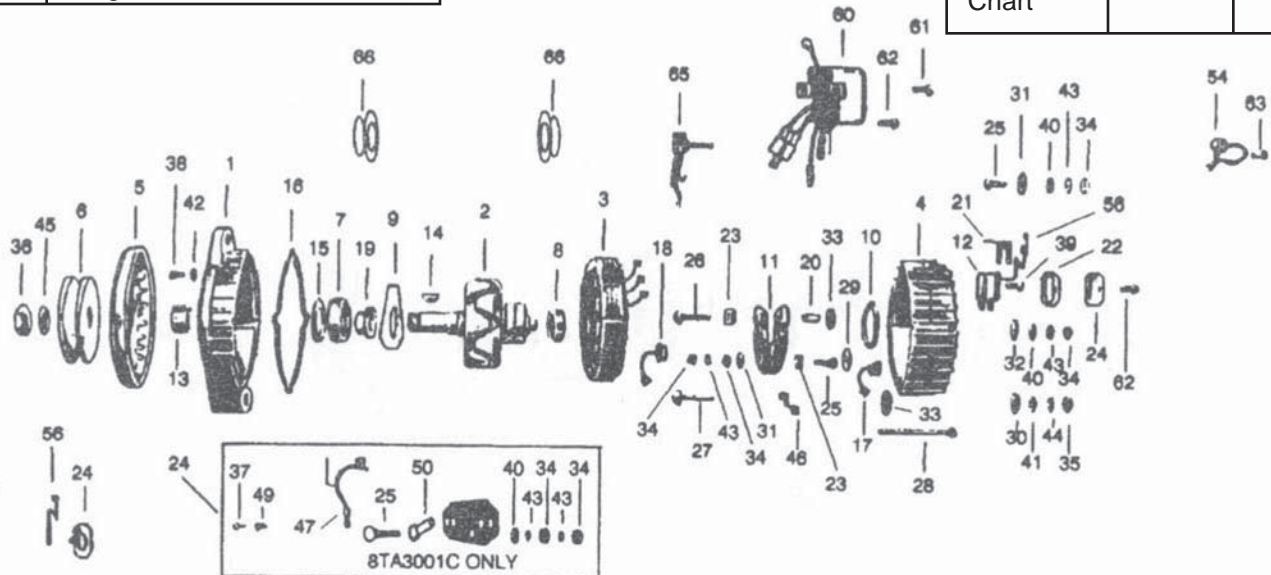

MODEL NO.	SALES NO.	1 HSNF FRONT	2 ROTOR ASSEM	3 STATOR ASSEM	4 HSNF REAR	5 FAN	6 PULLEY	7 BRNG FRONT	8 BRNG REAR	9 FR. BRNG RET	10 R. BRNG RET	11 HEAT SINK POS.	12 BRUSH ASSEM.
8TA2002E	110-145	114-88	112-14	113-11	114-91	107-31		111-21	111-23	111-27	111-25	101-32	103-24
8TA2003D	110-148	114-20	112-14	113-10	114-91		107-46	111-21	111-23	111-27	111-25	101-32	103-24
8TA2005D		114-61	112-14	113-10	114-91			111-40	111-23	111-27	111-25	101-32	103-24
8TA2006D	110-170	114-61	112-14	113-10	114-91		107-30	111-21	111-23	111-27	111-25	101-32	103-24
8TA2007D		114-61	112-14	113-10	114-91		107-43	111-21	111-23	111-27	111-25	101-32	103-24
8TA2009E	110-166	114-61	112-14	113-11	114-91		107-37	111-21	111-23	111-27	111-25	101-32	103-24
8TA2010E	110-190	114-20	112-14	113-11	114-91	107-31		111-21	111-23	111-27	111-25	101-32	103-24
8TA2011E	110-189	114-111	112-14	113-11	114-91	107-31		111-21	111-23	111-27	111-25	101-32	103-24
8TA2012E	110-169	114-88	112-14	113-11	114-91	107-31		111-21	111-23	111-27	111-25	101-32	103-24
8TA2013D		114-88	112-14	113-11	114-91	107-31		111-21	111-23	111-27	111-25	101-32	103-24
8TA2014D	110-168	114-20	112-14	113-10	114-91	107-31		111-21	111-23	111-27	111-25	101-32	103-24
8TA2015E		114-61	112-14	113-10	114-91	107-31		111-21	111-23	111-27	111-25	101-32	103-24
8TA2016F		114-112	112-14	113-11	114-91	107-31		111-40	111-23	111-27	111-25	101-32	103-24
8TA2017D	110-171	114-61	112-14	113-10	114-91			111-40	111-23	111-27	111-25	101-32	103-24
8TA2018D	110-207	114-113	112-14	113-10	114-91	107-31		111-40	111-23	111-27	111-25	101-32	103-24
8TA2019E	110-204	114-20	112-14	113-11	114-91	107-31		111-21	111-23	111-27	111-25	101-32	103-24
8TA2021E		114-20	112-14	113-11	114-91		107-78	111-21	111-23	111-27	111-25	101-32	103-24
8TA2022D	110-206	114-119	112-14	113-10	114-91			111-40	111-23	111-27	111-25	101-32	103-24
8TA2023D		114-20	112-14	113-10	114-91	107-31		111-21	111-23	111-27	111-25	101-32	103-24
8TA2024D	110-220	114-140	112-14	113-10	114-91			111-21	111-23	111-60	111-25	101-32	103-24
8TA2026E	110-231	114-20	112-14	113-11	114-91			111-21	111-23	111-27	111-25	101-32	103-24
8TA2027D	110-226	114-140	112-14	113-10	114-91			111-21	111-23	111-27	111-25	101-32	103-24
8TA2028E	110-232	114-20	112-14	113-11	114-91	107-31		111-21	111-23	111-27	111-25	101-32	103-43
8TA2029E	110-414	114-88	112-71	113-62	114-91	107-31	107-65	111-21	111-23	111-27	111-25	101-32	103-43
8TA2030G	110-458	114-262	112-82	113-72	114-91	107-31		111-21	111-23	111-27	111-25	101-32	103-43
8TA2031G	110-475	114-266	112-82	113-72	114-265	107-31	107-61	111-21	111-23	111-27	111-25	101-32	103-24
8TA2032E	110-551	114-262	112-71	113-62	114-91	107-31		111-21	111-23	111-27	111-25	101-32	103-43
8TA2034G	110-552	114-262	112-82	113-72	114-91	107-31		111-21	111-23	111-27	111-25	101-32	103-43
8TA3001C		114-83	112-14	113-31	114-91	107-31		111-40	111-23	111-27	111-25	101-32	103-22
8TA3020C	110-202	114-119	112-35	113-31	114-91			111-40	111-23	111-27	111-25	101-32	103-43
8TA3025C	110-221	114-140	112-35	113-31	114-91			111-21	111-23	111-60	111-25	101-32	103-43
8TA3052C	110-227	114-119	112-35	113-31	114-91	107-31		111-40	111-23	111-27	111-25	101-32	103-43

Important: The information contained in this bulletin is intended for use by trained, professional technicians who have the proper tools, equipment, and training to perform the required maintenance described above. This information is NOT intended for 'do-it-yourselfers', and you should not assume that this information applies to your equipment. If you have any questions regarding this information please visit our website at www.prestolite.com, or contact our technical service department at:

GROUP:	22
FORM:	8TA

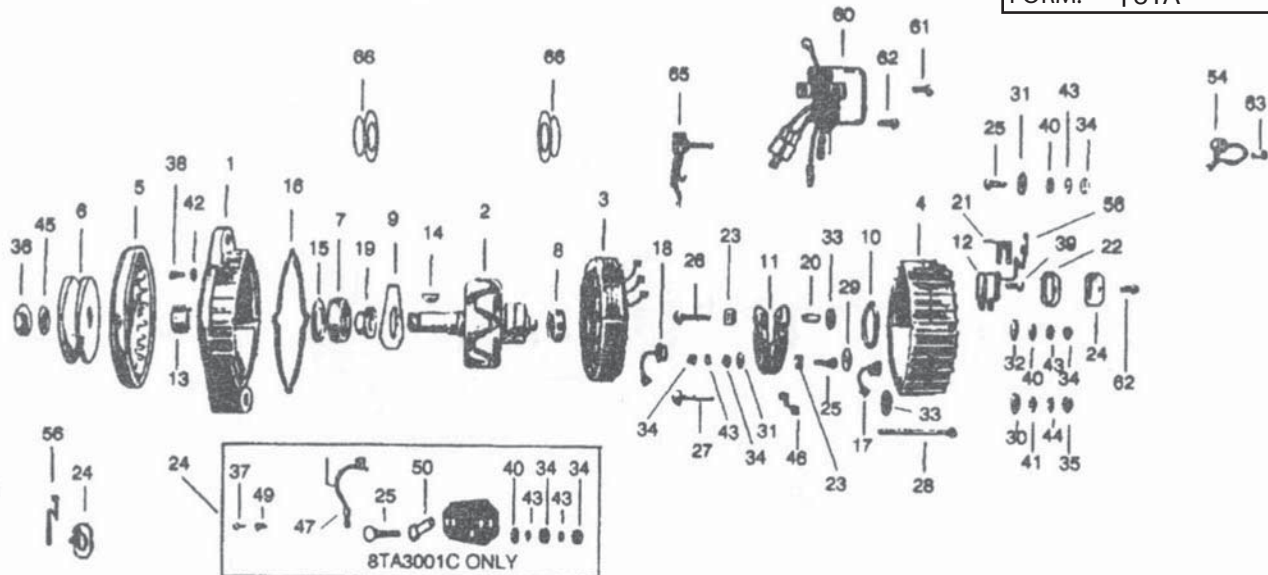

MODEL NO.	SALES NO.	13 SPACER FAN	14 WDRFF KEY	15 SEAL FT BRNG	16 GASKET HSNG	17 DIODE REC. NEG	18 DIODE REC. POS	19 SLEEVE SHAFT	20 INSUL. SLEEVE	21 INSUL. BRUSH	22 GASKET COVER	23 INSUL. SQUARE	24 COVER BRUSH
8TA2002E	110-145	120-152	120-7		114-22	101-34	101-33	120-89	115-9	115-19	103-10	115-7	103-25
8TA2003D	110-148	120-209	120-7	111-14	114-22	101-34	101-33		115-9	115-19	103-10	115-7	103-25
8TA2005D		120-147	120-7	111-14	114-22	101-34	101-33	120-89	115-9	115-19	103-10	115-7	103-25
8TA2006D	110-170	120-209	120-7	111-14	114-22	101-34	101-33		115-9	115-19	103-10	115-7	103-25
8TA2007D		120-209	120-7	111-14	114-22	101-34	101-33		115-9	115-19	103-10	115-7	103-25
8TA2009E	110-166	120-209	120-7	111-14	114-22	101-34	101-33		115-9	115-19	103-10	115-7	103-25
8TA2010E	110-190	120-152	120-7	111-14	114-22	101-34	101-33		115-9	115-19	103-10	115-7	103-25
8TA2011E	110-189	120-152	120-7	111-14	114-22	101-34	101-33	120-89	115-9	115-19	103-10	115-7	103-25
8TA2012E	110-169	120-152	120-7	111-14	114-22	101-34	101-33	120-89	115-9	115-19	103-10	115-7	103-25
8TA2013D		120-152	120-7	111-14	114-22	101-34	101-33	120-89	115-9	115-19	103-10	115-7	103-25
8TA2014D	110-168	120-152	120-7	111-14	114-22	101-34	101-33	120-89	115-9	115-19	103-10	115-7	103-25
8TA2015D		120-152	120-7	111-14	114-22	101-34	101-33		115-9	115-19	103-10	115-7	103-25
8TA2016F		120-147	120-7	111-14	114-22	101-34	101-33	120-89	115-9	115-19	103-10	115-7	103-25
8TA2017D	110-171	120-147	120-7	111-14	114-22	101-34	101-33	120-89	115-9	115-19	103-10	115-7	103-25
8TA2018D	110-207	120-147	120-7	111-14	114-22	101-34	101-33	120-89	115-9	115-19	103-10	115-7	103-25
8TA2019E	110-204	120-147	120-7	111-14	114-22	101-34	101-33		115-9	115-19	103-10	115-7	103-25
8TA2021E		120-209	120-7	111-14	114-22	101-34	101-33		115-9	115-19	103-10	115-7	103-25
8TA2022D	110-206	120-147	120-7	111-18	114-22	101-34	101-33	120-89	115-9	115-19	103-10	115-7	103-25
8TA2023D		120-147	120-7	111-14	114-22	101-34	101-33		115-9	115-19	103-10	115-7	103-25
8TA2024D	110-220	120-152	120-7	111-61	114-22	101-34	101-33		115-9	115-19	103-10	115-7	103-25
8TA2026E	110-231	120-152	120-7	111-14	114-22	101-34	101-33		115-9	115-19	103-10	115-7	103-25
8TA2027D	110-226	120-147	120-7		114-22	101-34	101-33		115-9	115-19	103-10	115-7	103-25
8TA2028E	110-232	120-152	120-7	111-14	114-22	101-34	101-33		115-9	115-19	103-10	115-7	103-34
8TA2029E	110-414	120-209	120-7	111-14	114-22	101-34	101-33		115-9	115-19	103-10	115-7	103-34
8TA2030G	110-458	120-375	120-7	111-14	114-22	101-34	101-33		115-9	115-19	103-10	115-7	103-34
8TA2031G	110-475	120-375	120-7	111-14	114-22	101-34	101-33		115-9	115-19	103-10	115-7	
8TA2032E	110-551	120-375	120-7	111-14	114-22	101-34	101-33		115-9	115-19	114-22	115-7	103-34
8TA2034G	110-552	120-375	120-7	111-14	114-22	101-34	101-33		115-9	115-19	103-10	115-7	103-34
8TA3001C		120-152	120-7	111-14	114-22	101-88	101-89	120-89	115-9	115-19	103-10	115-7	103-23
8TA3020C	110-202	120-147	120-7	111-18	114-22	101-88	101-89	120-89	115-9	115-19	103-10	115-7	103-34
8TA3025C	110-221	120-209	120-7	111-61	114-22	101-88	101-89		115-9	115-19	103-10	115-7	103-34
8TA3052C	110-227	120-147	120-7	111-76	114-22	101-88	101-89	120-89	115-9	115-19	103-10	115-7	103-25

Important: The information contained in this bulletin is intended for use by trained, professional technicians who have the proper tools, equipment, and training to perform the required maintenance described above. This information is NOT intended for 'do-it-yourselfers', and you should not assume that this information applies to your equipment. If you have any questions regarding this information please visit our website at www.prestolite.com, or contact our technical service department at:

SERVICE PARTS LIST

GROUP:	22
FORM:	8TA

KEY NO.	SALES NO.	DESCRIPTION	8TA2002E	8TA2003D	8TA2005D	8TA2006D	8TA2007D	8TA2009E	8TA2010E	8TA2011E	8TA2012E	8TA2013D	8TA2014D	8TA2015D	8TA2016F	8TA2017D	8TA2018D	8TA2019E	8TA2021E	8TA2022D	8TA2023D	8TA2024D	8TA2026E	8TA2027D	8TA2028E	8TA2029E	8TA2030G	8TA2031G	8TA2032E	8TA2034G	8TA3001C	8TA3020C	8TA3025C	8TA3052C	
		BOLTS																																	
25	120-135	CARRIAGE, 10-24x3/4"	3	3	3	3	3	3	3	3	3	3	3	3	3	3	3	3	3	3	3	3	3	3	3	3	3	3	3	3	3	3	3	3	
25	120-306	CARRIAGE, M5 x .8																										2							
26	120-93	CARRIAGE, 10-24x1-3/8"	2	2	2	2	2	2	2	2	2	2	2	2	2	2	2	2	2	2	2	2	2	2	2	1	1	1		1	1	2	1	1	
27	120-94	CARRIAGE, 1/4-28x1-3/4"	1	1	1	1	1	1	1	1	1	1	1	1	1	1	1	1	1	1	1	1	1	1	1	1	1	1	1	1	1	1	1	1	
27	120-371	CARRIAGE, M6-1 x 2.12																										1							
28	120-143	THROUGH, 10-32x3-1/8"	4	4	4	4	4	4	4	4	4	4	4	4	4	4	4	4	4	4	4	4	4	4	4	4	4	4	4	4	4	4	4	4	
		INSULATORS																																	
29	115-16	MICA 7/8" OD	3	3	3	3	3	3	3	3	3	3	3	3	3	3	3	3	3	3	3	3	3	3	3	3	3	3	3	3	3	3	3	3	
30	115-12	MOLDED RND, 1/4" STUD x 5/8" OD	1	1	1	1	1	1	1	1	1	1	1	1	1	1	1	1	1	1	1	1	1	1	1	1	1	1	1	1	1	1	1	1	
31	115-4	WASHER, NO. 10 STUD x 1/2" OD	4	4	4	4	4	4	4	4	4	4	4	4	4	4	4	4	4	4	4	4	4	4	4	4	4	4	4	3	4	4	4	4	
32	115-3	WASHER, NO. 10 STUD x 3/4" OD	2	2	2	2	2	2	2	2	2	2	2	2	2	2	2	2	2	2	2	2	2	2	2	1	1	1	1	1	1	2	1	1	
33	115-10	WASHER, 1/4" STUD X 3/4" OD																										1	1	1	1				
33	115-82	WASHER, NO. 10 STUD X 9/16" OD																										1	1	1	1				
33	115-83	WASHER, 1/4" STUD X .48" OD																										1	1	1	1				
33	115-15	WASHER, 1/4" STUD x 3/4" OD	1	1	1	1	1	1	1	1	1	1	1	1	1	1	1	1	1	1	1	1	1	1	1	1					1	1	1	1	
		NUTS																																	
34	120-34	HEX, 10-24	8	8	8	8	8	8	8	8	8	8	8	8	8	8	8	8	8	8	8	8	8	8	8	8	5	3	3		8	8	8	8	
34	120-148	HEX LOCK, 10-24	3	3	3	3	3	3	3	3	3	3	3	3	3	3	3	3	3	3	3	3	3	3	3	3	2			2	3	3	3	3	
34	120-95	HEX, 10-24 NUT																										3	6	3	3				
34	120-254	HEX, M5 X .8																										4							
35	120-115	HEX, 1-4-28	2	2	2	2	2	2	2	2	2	2	2	2	2	2	2	2	2	2	2	2	2	2	2	2	1				2	2	2	2	
35	120-268	HEX, M6 x 1.0																										3							
35	120-377	NUT, 1/4-28																												2					
35	120-342	NUT, 1/4-20																												1					
31	120-136	PULLEY MOUTING, 5/8-18	1	1	1	1	1	1	1	1	1	1	1	1	1	1	1	1	1	1	1	1	1	1	1	1	1	1	1	1	1	1	1	1	
		SCREWS																																	
37	120-196	MACHINE, 6-32 x 3-16"																													2				
38	120-141	MACHINE, 8-32 x 3/8"	3	3	3	3	3	3	3	3	3	3	3	3	3	3	3	3	3	3	3	3	3	3	3	3	3	3	3	3	3	3	3	3	
39	120-102	TAPPING, 8-32 x 1/2"	2	2	2	2	2	2	2	2	2	2	2	2	2	2	2	2	2	2	2	2	2	2	2	2	2	2	2	2	2	2	2	2	
61	120-234	TAPPING, 10-24 x 3/8"		1	1		1										1	1	1		1	1	1	1	1	1	2	2	2			1	1		
62	120-223	TAPPING, 10-24 x 5/8"	2	2	2	2	2	2	2	2	2	2	2	2	2	2	2	2	2	2	2	2	2	2	2	2	2	2	2	2	2	2	2	2	
63	120-224	TAPPING, 10-32 x 3/8"		1	1	1	1	1	1	1	1	1	1	1	1	1	1	1		1		1	1	1	1						1	1	1		
		WASHERS																																	
40	120-120	FLAT METAL, NO. 10 STUD x 7/16"	4	4	4	4	4	4	4	4	4	4	4	4	4	4	4	4	4	4	4	4	4	4	4	4	2	2	2	2	4	4	4	4	
41	120-109	FLAT METAL, 1/4" STUD x 9/16"	1	1	1	1	1	1	1	1	1	1	1	1	1	1	1	1	1	1	1	1	1	1	1	1	1	1	1	1	1	1	1	1	
42	120-142	SPLIT LOCK, NO. 8 STUD	3	3	3	3	3	3	3	3	3	3	3	3	3	3	3	3	3	3	3	3	3	3	3	3	3	3	3	3	3	3	3	3	
43	120-111	SPLIT LOCK, NO. 10 STUD	4	4	4	4	4	4	4	4	4	4	4	4	4	4	4	4	4	4	4	4	4	4	4	4	5	3	3		4	4	4	4	
44	120-113	SPLIT LOCK, 1/4" STUD	2	2	2	2	2	2	2	2	2	2	2	2	2	2	2	2	2	2	2	2	2	2	2	2	1			2	2	2	2		
44	120-373	SPLIT LOCK																										3							
45	120-137	SPLIT LOCK, 5/8" STUD	1	1	1	1	1	1	1	1	1	1	1	1	1	1	1	1	1	1	1	1	1	1	1	1	1	1	1	1	1	1	1	1	

Important: The information contained in this bulletin is intended for use by trained, professional technicians who have the proper tools, equipment, and training to perform the required maintenance described above. This information is NOT intended for 'do-it-yourselfers', and you should not assume that this information applies to your equipment. If you have any questions regarding this information please visit our website at www.prestolite.com , or contact our technical service department at:

SERVICE PARTS LIST

GROUP:	22
FORM:	8TA

KEY NO.	SALES NO.	DESCRIPTION	8TA2002E	8TA2003D	8TA2005D	8TA2006D	8TA2007D	8TA2009E	8TA2010E	8TA2011E	8TA2012E	8TA2013D	8TA2014D	8TA2015D	8TA2016F	8TA2017D	8TA2018D	8TA2019E	8TA2021E	8TA2022D	8TA2023D	8TA2024D	8TA2026E	8TA2027D	8TA2028E	8TA2029E	8TA2030G	8TA2031G	8TA2032E	8TA2034G	8TA3001C	8TA3020C	8TA3025C	8TA3052C
		MISC.																																
46	116-44	CABLE, CONNECTOR	1	1	1	1	1	1	1	1	1	1	1	1	1	1	1	1	1	1	1	1	1	1	1	1	1	1	1	1	1	1	1	1
46	116-113	CABLE, CONNECTOR BRUSH	1	1	1	1	1	1	1	1	1	1	1	1	1	1	1	1	1	1	1	1	1	1	1	1	1	1	1	1	1	1	1	1
47	116-91	CABLE, BRUSH ASSEMBLY																																
49	*	RIVET																																
50	*	TERMINAL LUG																																
54	102-40	CAPACITOR	1	1	1	1	1	1	1	1	1	1	1	1	1	1	1	1	1	1	1	1	1	1	1	1	1	1	1	1	1	1	1	1
56	116-79	CABLE, CONN. (FIELD JUMPER)	1	1	1	1	1	1	1	1	1	1	1	1	1	1	1	1	1	1	1	1	1	1	1	1	1	1	1	1	1	1	1	1
46	116-136	CABLE CONNECTOR (TRIO)																																
60	105-104	VOLTAGE REGULATOR (8RF2001)	1	1																														
60	105-167	VOLTAGE REGULATOR (8RF2015)																																
60	105-164	VOLTAGE REGULATOR (8RF3013)																																
60	105-121	VOLTAGE REGULATOR (8RF2003)																																
60	105-219	VOLTAGE REGULATOR (8RF2019A)																																
60	105-281	VOLTAGE REGULATOR (8RF2027)																																
60	105-302	VOLTAGE REGULATOR (8RF2028)																																
60	105-305	VOLTAGE REGULATOR 8RF2030																																
60	105-334	VOLTAGE REGULATOR																																
65	101-131	FIELD DIODE																																
66	111-62	"V" RING																																
		*NOT AVAILABLE SEPARATELY																																

Important: The information contained in this bulletin is intended for use by trained, professional technicians who have the proper tools, equipment, and training to perform the required maintenance described above. This information is NOT intended for 'do-it-yourselfers', and you should not assume that this information applies to your equipment. If you have any questions regarding this information please visit our website at www.prestolite.com, or contact our technical service department at: