

GROUP:	4629-4630JA
FORM:	4331-982
FILE:	Alternator Parts List Section
DATE:	September, 1982

PRODUCTS COVERED

MODEL	VOLTS	AMPS	NSN
4629JA	28	100	6115-01-131-4932
4630JA	28	65	6115-01-131-4931

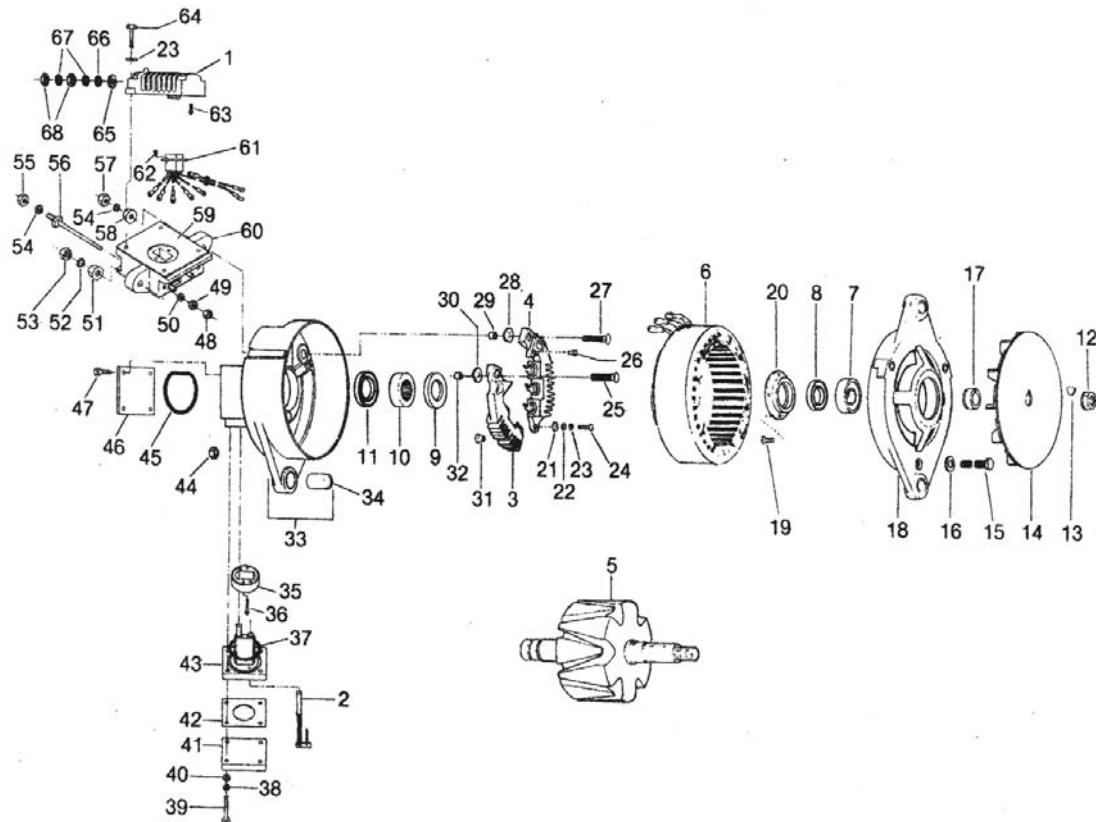

Ref. No.	Part No.	Qty.	Description	Ref. No.	Part No.	Qty.	Description
1	*95300	1	Regulator	14	79035	1	Fan
2	*99516	2	Brush	15	95152	3	Screw, 10-32 x 5.28"
3	*71237	1	Positive rectifier assy.	16	79627	3	Guard washer
4	*71238	1	Negative rectifier assy.	17	59225	1	Spacer, fan
5	*79517	1	Rotor assy.	18	*78983	1	Housing, DE
6	*99789	1	Stator assy. (4629JA only)	19	58754	4	Screw, 10-32 x .44 Fl. Hd. St.
6	*99793	1	Stator assy. (4630JA only)	20	79486	1	Retainer bearing
7	*78895	1	DE bearing, 305	21	*52066	2	Insulation, washer
8	*79405	1	Seal	22	2385	2	Guard washer, #10
9	*79404	1	Seal	23	2434	6	Lockwasher, #10
10	*79406	1	SR bearing, 203	24	78337	2	Screw, 10-32 x .75 Pan Hd. St.
11	*79403	1	Seal	25	78997	1	Output terminal screw, 5/16"
12	76985	1	Nut, 5/8-18 Hex. Fl. lock	26	73543	3	Screw, 6-32 Hex. Hd. S'tap
13	6399	1	Key, Woodruff #8	27	79313	1	Output terminal screw, 1/4"

\* Suggested Service Parts

Important: The information contained in this bulletin is intended for use by trained, professional technicians who have the proper tools, equipment, and training to perform the required maintenance described above. This information is NOT intended for 'do-it-yourselfers', and you should not assume that this information applies to your equipment. If you have any questions regarding this information please visit our website at [www.prestolite.com](http://www.prestolite.com), or contact our customer service department at:

**SERVICE PARTS LIST  
4629JA and 4630JA**

GROUP:	4629-4630JA
FORM:	4331-982

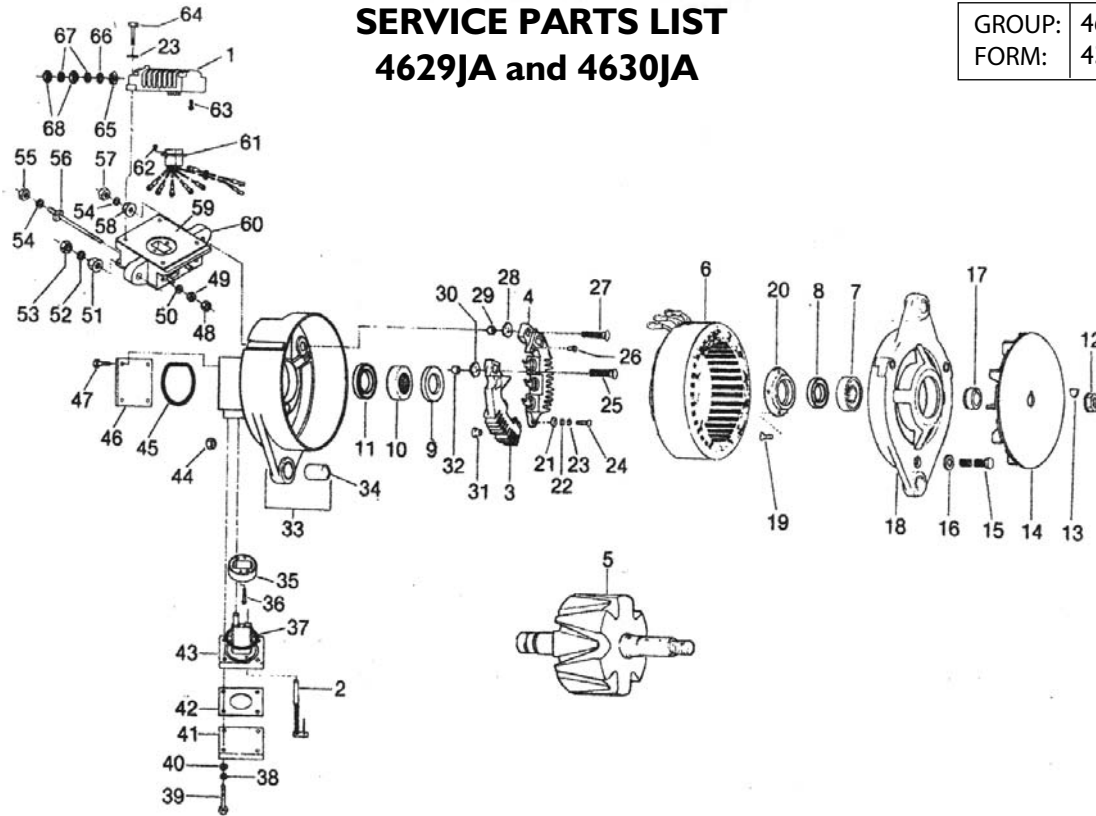

Ref. No.	Part No.	Qty.	Description	Ref. No.	Part No.	Qty.	Description
28	*73545	1	Insulation bushing	49	2313	3	Nut, 10-32 Hex.
29	*79070	1	Insulation bushing	50	79469	3	Guard washer
30	*73546	1	Insulation bushing	51	73009	1	Nut, Tenz 5/16-18
31	*73547	2	Insulation bushing	52	3231	1	Lockwasher, 5/16
32	*79071	1	Insulation bushing	53	2364	1	Nut, 5/16-18 Hex. St.
33	*95279	1	Housing, SRE	54	2523	4	Lockwasher, 1/4
34	*77916	1	Bushing, slideable	55	3395	3	Nut, 1/4-20 Hex.
35	99508	1	Brush holder adapter	56	99513	3	AC Terminal stud
36	13747	2	Screw, 6-32 x .62 rd. Hd. St.	57	2771	1	Nut, Tenz 1/4-20
37	*99514	1	"O" ring	58	59982	1	Nut, Tenz 1/4-20
38	2435	4	Lockwasher, #8	59	*99515	1	Regulator gasket
39	99524	4	Screw, 8-32 x 1" Hex. Hd. St.	60	99478	1	Regulator holder
40	36912	4	Guard washer, #8	61	*99481	1	Connector assy.
41	99517	1	Brush cover	62	13771	2	Screw, 10-32 x .5 Hex. Hd. St.
42	*99518	1	Gasket, brush holder	63	99459	1	Screw, 6-32 x 1/4" Pan Hd.
43	99479	1	Brush holder	64	99525	4	Screw, 10-32 x 1" Hex. Hd. St.
44	74732	3	Nut, 10-32 Fl. lock	65	* 7983	1	Insulation washer
45	*99511	1	"O" ring	66	5413	1	Flat washer
46	99512	1	Cover plate	67	31256	2	Lockwasher, S' proof
47	75348	4	Screw, 10-32 x .5 Hex. Hd. St.	68	4340	2	Nut, 10-24 Hex.
48	31587	3	Nut, 10-32 Hex.				

\* Suggested Service Parts

Important: The information contained in this bulletin is intended for use by trained, professional technicians who have the proper tools, equipment, and training to perform the required maintenance described above. This information is NOT intended for 'do-it-yourselfers', and you should not assume that this information applies to your equipment. If you have any questions regarding this information please visit our website at [www.prestolite.com](http://www.prestolite.com), or contact our customer service department at: